

Integrattech LINEAR TRACK creates a new idea of track lighting for retail spaces with its driver in rail design. The super slim design without visible driver realizes the perfect combination between rail and luminaire. Suitable for Global, Eutrac, Staff, Ivela, Unipro, Stucchi and Erco 3-phase rails. Phase and power selection with dip switch. Adjustable power between 20 and 61W.

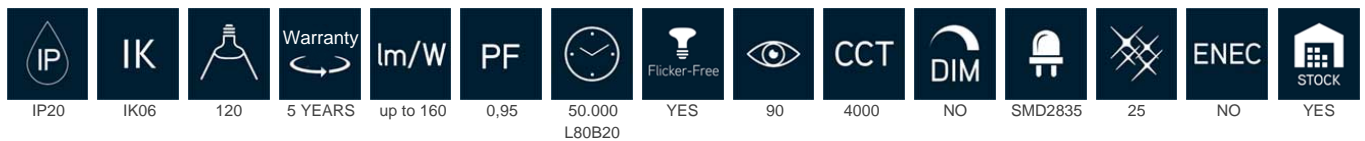

### Technical specifications

Referentie	LT15614R120
EAN code	5420076264024
ETIM code	EC001744

### Electrical specifications

System power (W)	64,2
LED power (W)	59,97
Input voltage (Vac)	220-240
Frequency (Hz)	50/60
Driver included	yes
Driver intern/extern	intern
Driver brand	VOSSLOH SCHWABE
Driver reference	ECXE 400.599
Dimmable	nee
Flicker free	yes
Power factor	0,95
THD	<20%
Driver output (V)	150-180
Driver output (mA)	95-360
Isolation class	I
Energy class	D
N° circ. breaker 16A B	
N° circ. breaker 16A C	36
N° circ. breaker 16A D	
Inrush current	33A 250µs

### Warranty and certification

Lifetime (h)	50.000 L80B20
Warranty (years)	5 (excluding batteries)
ENEC	no

### Photometric specifications

Light angle (°)	120
Color temperature (K)	4000
CRI	90
UGR	25
SDCM	<4
Lumen output (Lm)	9600
Lm/W	160
Flux code	44 74 92 90 100
Ledchip	SMD2835
Led manufacturer	Edison
N° of LEDs	165
Photobiological class	RG0

### Dimensions and material properties

Dimensions (LxBxH)	1504x64x54mm
Weight (kg)	1,5
Color	white RAL9016
Working temp. (°C)	-20~+60
IP value	IP20
IK value	IK06
UV resistant	yes
Seawater resistant	no
UL94	
N° in masterbox	10
N° on pallet	120
MOQ	1
Stock item	yes
EPA	

### Lumen distributio

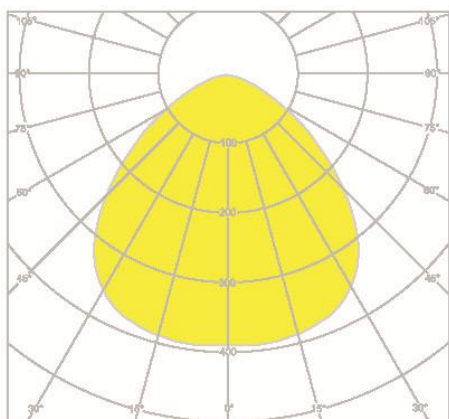

### Distance curve:

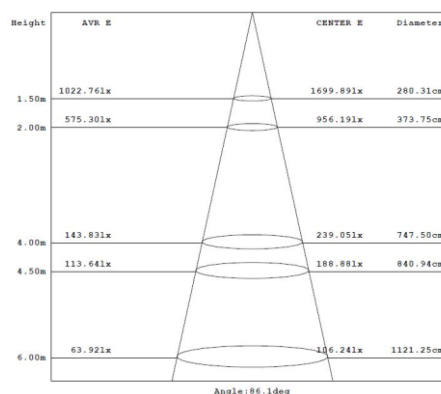

### Spectrum distributio

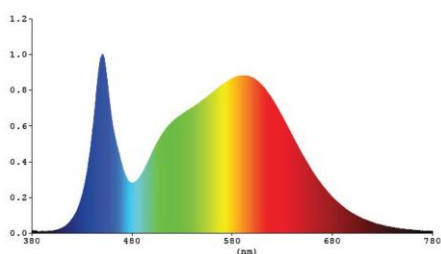

### Lumendrop

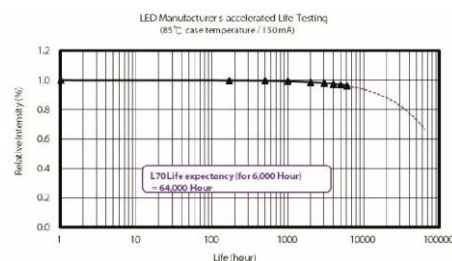

Dimensions

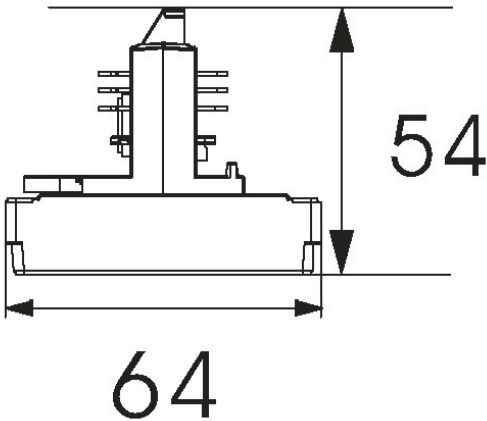

Connection diagram

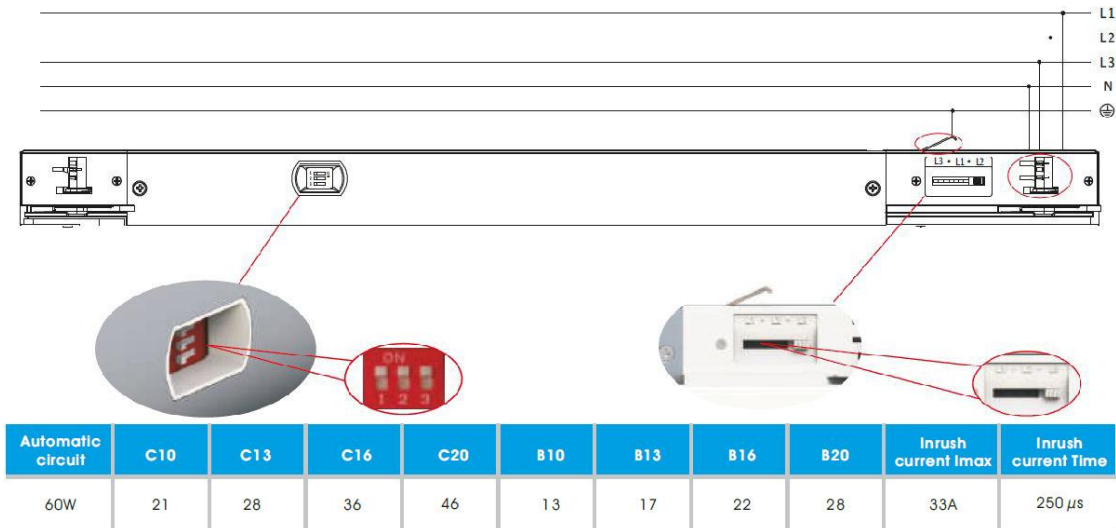

Harmonic

Total harmonic distortion < 20%

Standards

EN 55015/EN 61000-3-2/EN 61000-3-3/EN 61347-1  
EN 61347-2-13/EN 61547/EN 61000-4-4/EN 61000-4-5